

# T93P



## Product Features

- Adjustable power size EN 2~5
- Adjustable closing & latching speed
- Adjustable back check
- Adjustable delay action
- Thermo-constant valve
- Surface mount
- Cam action
- Track arm
- Single-action door
- Non-handed installation
- Compatible with Fortress electromagnetic hold-open application (EHO)

Power size	2~5
Max. Door width (mm)	1250
Max. Opening Angle	180

## Application Ranges

- B type : Door mount pull side & transom mount push side
- G type : Door mount push side & transom mount pull side

## Installation

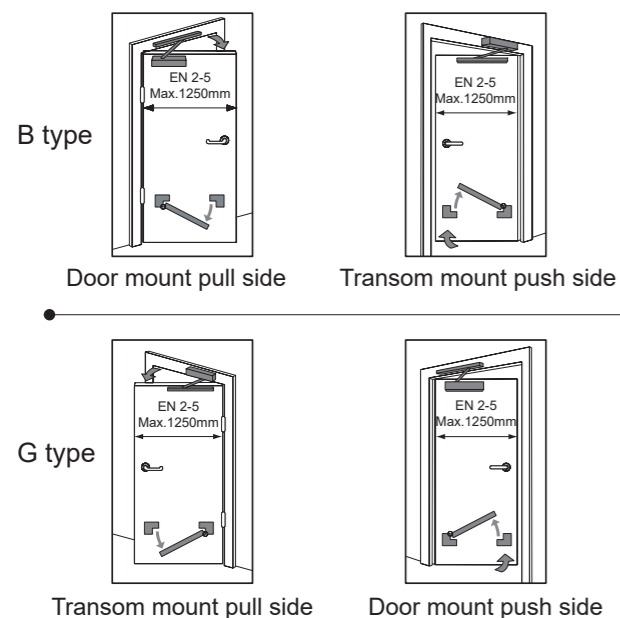

## Finishes

- Anodized aluminum for door closer body and track rail as standard
- Painted – silver, brown, gold, black, white & other RAL colors upon request & discussion
- Plating (for cover only) - US finish code colors upon request & discussion

## Dimensions

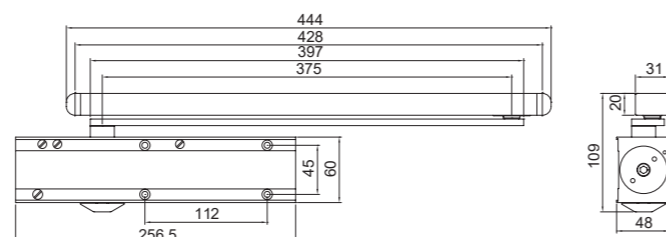

## Accessories

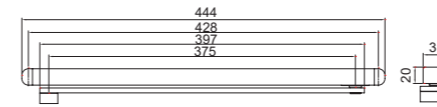

### ZAR-I111

- Track arm & rail
- EN Certified

## Options



### ZPA-T01

- Angle bracket
- G type push side

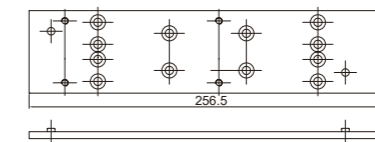

### ZMO-T09

- Mounting plate
- Accompanied with cover

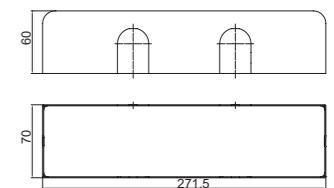

### ZCO-T05

- Metal cover (steel)
- Non-handed

### ZCO-T06

- Metal cover (stainless steel)
- Non-handed

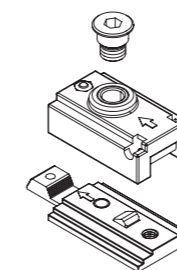

### ZSCR-T118

- Hold-open device
- For track arm & rail: ZAR-I111

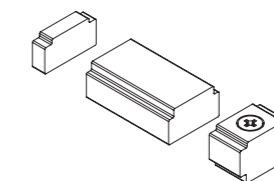

### ZSCR-T111

- Cushion
- For track arm & rail: ZAR-I111