

T91B



Product Features

- Fixed power size EN 3
- Adjustable closing & latching speed
- Thermo-constant valve
- Surface mount
- Cam action
- Track arm
- Single-action door
- Non-handed installation
- Compatible with Fortress electromagnetic hold-open application (EHO)

Power size	3
Max. Door width (mm)	950
Max. Opening Angle	180

Application Ranges

- B type: Door mount pull side & transom mount push side
- G type: Door mount push side & transom mount pull side

Installation

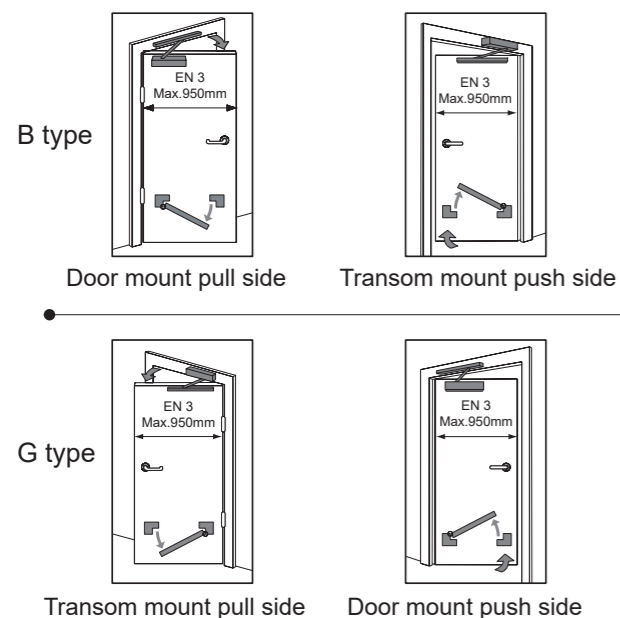

Finishes

- Anodized aluminum for door closer body and track rail as standard
- Painted – silver, brown, gold, black, white & other RAL colors upon request & discussion
- Plating (for cover only) - US finish code colors upon request & discussion

Dimensions

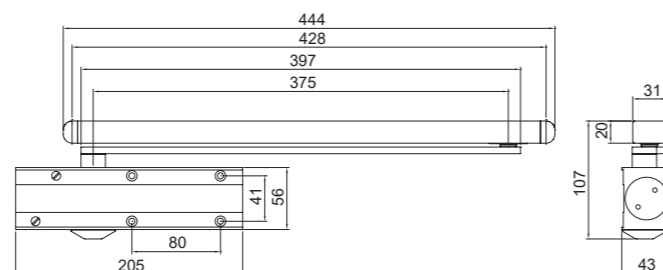

Accessories

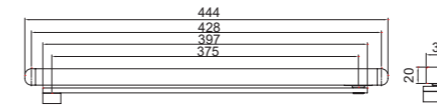

ZAR-I111

- Track arm & rail
- EN Certified

Options

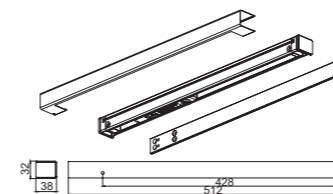

EHO

- Electromagnetic Hold-open device
- EN Certified

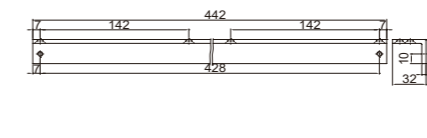

ZPA-T01

- Angle bracket
- G type push side

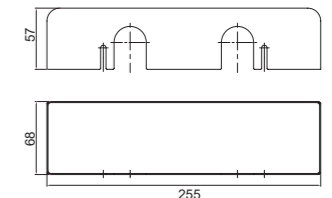

ZCO-T15

- Metal cover (steel)
- Non-handed

ZCO-T16

- Metal cover (stainless steel)
- Non-handed

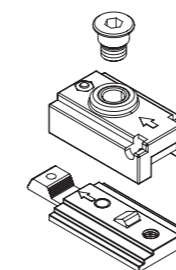

ZSCR-T118

- Hold-open device
- For track arm & rail: ZAR-I111

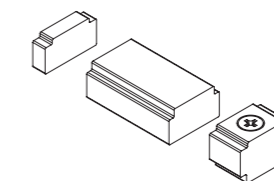

ZSCR-T111

- Cushion
- For track arm & rail: ZAR-I111

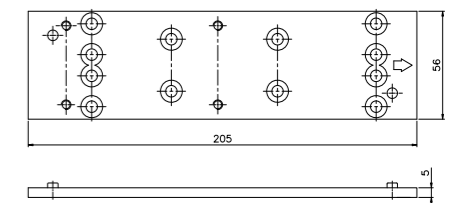

ZMO-T79

- Mounting plate