

7100 series

Vertical Rod Type (7100V & F7100V)

Specifications



3 HOUR FIRE RATED
UL10C, UBC7-2-1997
ANSI A156.3 G2

Material	Push bar – Steel pressed or stainless steel pressed Head Cover – Steel pressed or stainless steel pressed Spring – Stainless steel
Latch Bolt	5/8" throw, stainless steel
Dead Latch Bolt	9/16", steel
Strike	For 5/8" stop
Projection	2-1/2" maximum, 1-7/8" pressed
Reversible	Non-handed, reversible for all functions and trims
For Door	1-3/4" thick of wood or metal door.
Door Width	3' standard for door width of 29" to 36", 4' standard for door width of 41" to 48"
Stile	4-1/4" minimum
Top and bottom rod length for 7' door	Top rod 35-5/8", bottom rod 34-3/4"
Top and bottom rod length for 8' door	Top rod 47-5/8", bottom rod 34-3/4"
Mounting Height	40-5/16" from CL to finished floor recommended
Mounting	Furnished standard with sheet metal & machine screws or SNB as option.
Cylinders	For trim, knob, lever & thumb-piece type "Schlage C" key way
Dogging	1/4 turn, hex key dogging on non-fire labeled device
UL Listed	For "Panic Hardware" and "UL". Labeled (3 hours) fire exit hardware.
Operation	Inside by slight pressure on any point of the push bar all time
Head Cover	8-1/2"x2-3/4"x2-1/2"(216mmx68.3mmx62mm)
Standard Finishes	US32D (or other available finishes upon request & discussion)

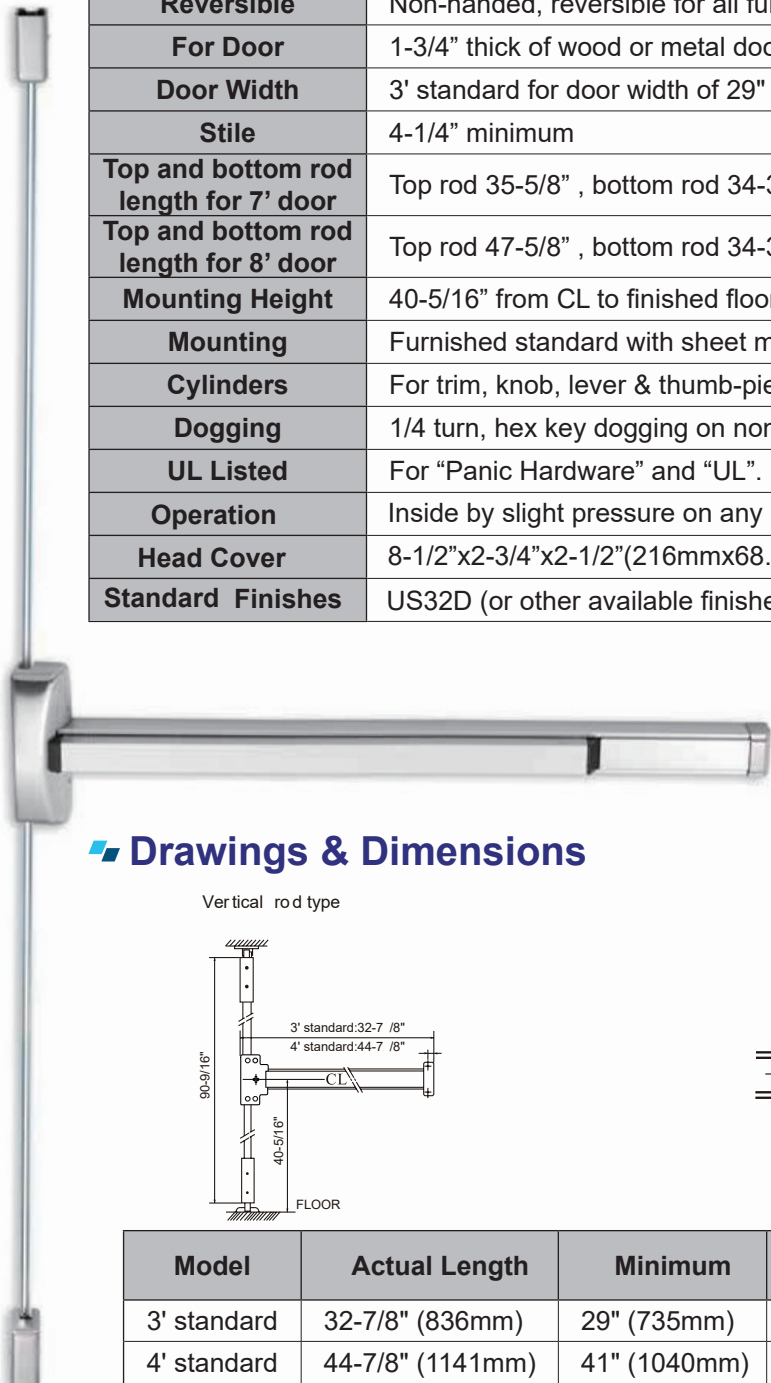

Drawings & Dimensions

Vertical rod type

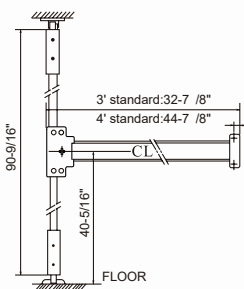

Mounting Position

For wood or metal door

Door Application Chart

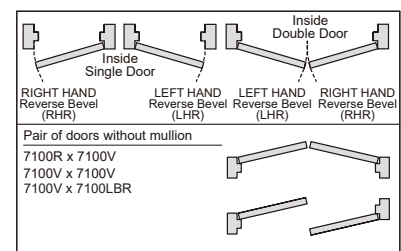
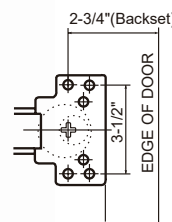

Model	Actual Length	Minimum	Door Size
3' standard	32-7/8" (836mm)	29" (735mm)	35" to 36" door width
4' standard	44-7/8" (1141mm)	41" (1040mm)	47" to 48" door width